



TOWNSHIP OF PERTH EAST
BUILDING DEPARTMENT

Telephone: (519) 595-2800 or

Toll Free: 1-888-712-0618

P.O. Box 455, 25 Mill Street East, Milverton, Ontario N0K 1M0

FAX: (519) 595-2801

APPLICATION FOR '911' NUMBER

Date: _____

Property Owner(s) Name: _____

Property Owner(s) Telephone Number: _____

Property Owner(s) Current Mailing Address: _____

Property Legal Description: _____

Property Roll Number: _____

Type of '911' Sign (Please Circle One): Blade and Post Blade Only 4" Owner Purchased
Number

N
↑

Sketch – Location of Entrance

PAID: _____
(Date)

Terms of Payment (Please Circle One): CASH

CHEQUE

INSTRUCTIONS FOR 911 NUMBER APPLICATION

1. WHERE PROPERTY HAS NEIGHBOURING PROPERTY WITH 911 NUMBER:

Measure from the middle of your entrance to the middle of the neighbouring property's entrance. Measurements can be in metric or imperial, but the measurement must be taken in a straight line. If the neighbour is on the opposite side of the street/road, measure from middle to middle but measure along the property line. For example:

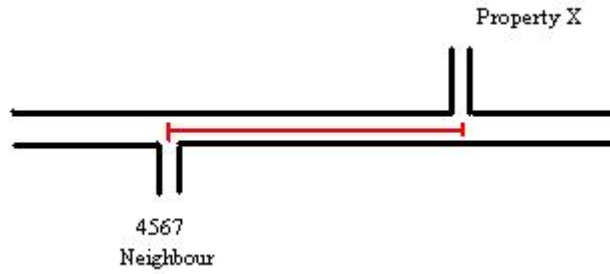

Draw your map as shown above. Please indicate the street/road name, the distance between the middle of each entrance/driveway and your neighbour's 911 number.

2. WHERE THE PROPERTY IS A CORNER LOT OR NEAR AN INTERSECTION:

Measure from the middle of your entrance to the middle of the intersection, as shown below and draw your map accordingly. Please indicate the street/road name your entrance is on and the distance measured.

